



TRAC

Aerial closure

The TRAC system from Tyco is a torchless closure for free-breathing aerial applications providing both an effective mechanical and environmental protection against water entry without tapes, mastic, clamps or special tools.

The TRAC product offers both venting and draining functions.

It consists of three main components: two gel sealing units and a central part. After splice preparation and bonding, the two gel end-pieces are placed over the cable(s). The central body is then closed over the end-pieces and splice to provide a secure cover. The body is locked by metal latches.

Features

TRAC is fast and easy to install, requiring only three parts for completion.

Easy re-entry of splice.

Only a few sizes of the TRAC aerial closure accommodate up to 1800 pair cable.

Different types of screen continuity are available to suit various aerial cabling conditions.

TRAC extension kits are available for long-length applications.

The closure accommodates both straight and branch configurations.

The TRAC closure is compatible with bond bars commonly used.

TRAC selection table

Dimensions (in mm)

Product description	Max. splice bundle diam.	Sheath opening	Max. cable configuration	Main cable diam.		Branch cable max. diam.	
				min.	max.	branch 1	branch 2
TRAC-AA-1	50	400	1 in, 1 out	7	29	-	-
TRAC-AA	50	250	2 in, 2 out	7	19	13	-
		400	2 in, 2 out	7	19	13	-
TRAC-A	75	300	2 in, 2 out	12	32	25	-
		450	2 in, 2 out	12	32	25	-
TRAC-B	125	500	2 in, 2 out	32	48	38	-
		650	2 in, 2 out	32	48	38	-
TRAC-B+	175	650	2 in, 2 out	32	65	65	-
		650	3 in, 3 out	32	48	30	30
TRAC-C	225	650	3 in, 3 out	36	83	50	38

Installation steps



1 Center the cables in the end-piece. Press the half shells together and lock.

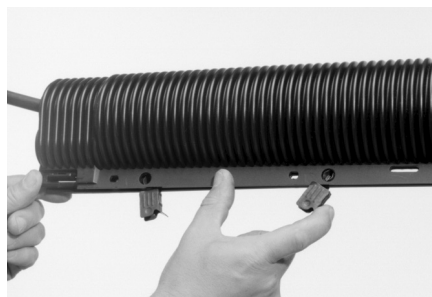

2 Place the central body over the end-pieces, close the central body over the splice and fasten snaps.

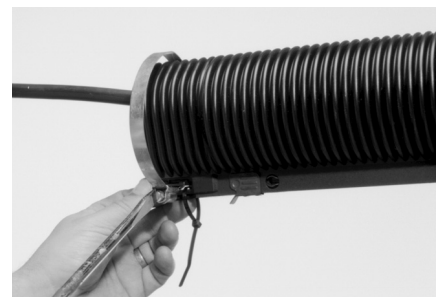

3 Place short tie-wraps in the hinge slots. Secure the central body by placing stainless steel quick release clamps around the body.

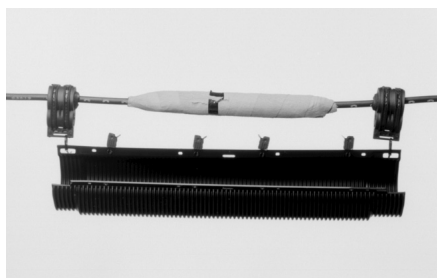

4 Re-entry

Remove the stainless steel quick release clamps, release snaps and open the body of the closure.

Tyco Electronics, TE logo and TRAC are trademarks

The information given herein, including drawings, illustrations and schematics which are intended for illustration purposes only, is believed to be reliable. However, Tyco Electronics makes no warranties as to its accuracy or completeness and disclaims any liability in connection with its use. Tyco Electronics' obligations shall only be as set forth in Tyco Electronics' Standard Terms and Conditions of Sale for this product and in no case will Tyco Electronics be liable for any incidental, indirect or consequential damages arising out of the sale, resale, use or misuse of the product. Users of Tyco Electronics products should make their own evaluation to determine the suitability of each such product for the specific application.

Tyco Electronics Raychem NV

Diestsesteenweg 692

3010 Kessel-Lo, Belgium

Tel 32-16 351 011 (USA)1-919-557-8900

Fax 32-16 351 697 (USA)1-919-557-8498

www.tycoelectronics.com

www.telecomosp.com

TC 213/DS/2 04/97