

Figure 1

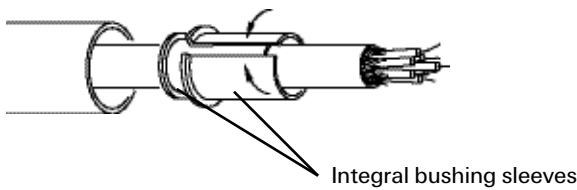

Figure 2

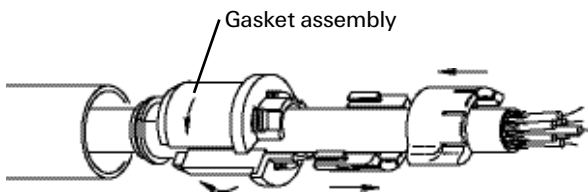

Figure 3

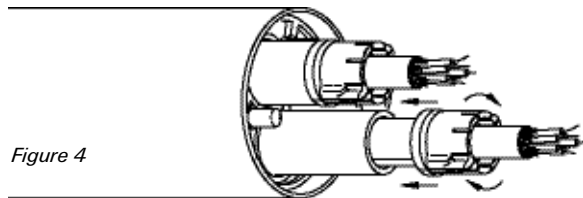

Figure 4

Product Selection

1. Determine the inside diameter of the outer duct and the outside diameter of the cable or inner duct. Select the correct plug from the chart on page 2.

Installation Instructions

1. Remove the top sealing collar and separate into two pieces as shown in Figure 1.
2. Some fiber optic simplex duct plugs come with integral bushing sleeves which are designed to be field-split for sealing around in-place cables when needed. Use scissors or snips to split the sleeves. Do not allow the splits in the bushings to overlap with the split in the main gasket assembly. (Figure 2)
3. Split the gasket assembly and place it around the bushings and the cable. Reassemble split collar around cable and thread onto gasket assembly. (Figure 3)
4. Slide assembled duct plug along cable into duct to be sealed. (Figure 4) Tighten by hand while holding in place. Complete sealing by tightening with a strap wrench.

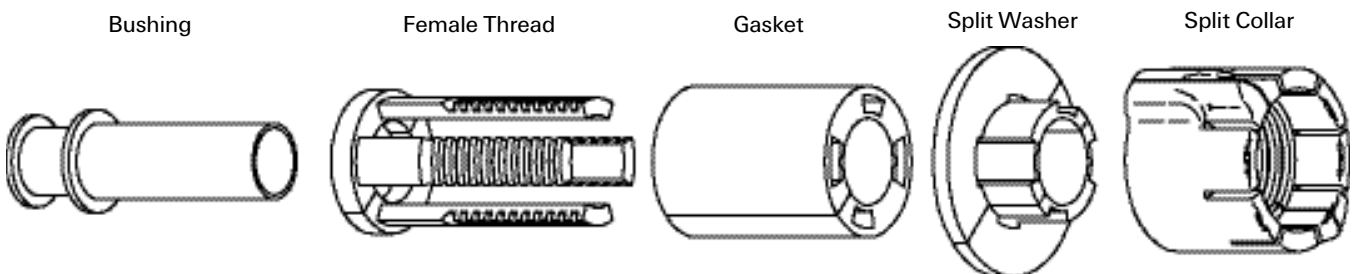

Fiber Optic Simplex Product Chart

Part No.	Description	Size	Duct ID		Cable OD	
			Inches	mm	Inches	mm
227094-000	JM-SIM-06S038S	0.600	0.63 - 0.71	16.0 - 18.0	0.33 - 0.39	8.4 - 9.9
136808-000	JM-SIM-06S038SB	0.600	0.63 - 0.71	16.0 - 18.0	0.27 - 0.39	6.9 - 9.9
E62262-000	JM-SIM-06035SB	0.700	0.74 - 0.80	18.8 - 20.3	0.27 - 0.35	6.9 - 8.9
A25290-000	JM-SIM-07S020SB	0.750	0.78 - 0.86	19.8 - 21.8	0.08 - 0.20	2.0 - 5.1
F11916-000	JM-SIM-07S035SB	0.750	0.78 - 0.86	19.8 - 21.8	0.20 - 0.35	5.1 - 8.9
D30443-000	JM-SIM-07S040SB	0.750	0.78 - 0.86	19.8 - 21.8	0.33 - 0.39	8.4 - 9.9
D43096-000	JM-SIM-07S050SB-043H	0.750	0.78 - 0.86	19.8 - 21.8	0.31 - 0.50	7.9 - 12.7
C00384-000	JM-SIM07S057SB	0.750	0.78 - 0.82	19.8 - 20.8	0.35 - 0.57	8.9 - 14.5
356346-000	JM-SIM-09S050SB	0.900	0.92 - 1.02	23.4 - 25.9	0.35 - 0.50	8.9 - 12.7
E43152-000	JM-SIM-09S050SB-043H	0.900	0.92 - 1.02	23.4 - 25.9	0.35 - 0.50	8.9 - 12.7
735672-000	JM-SIM-09S065SB	0.900	1.00 - 1.08	25.4 - 27.4	0.55 - 0.63	14.0 - 16.0
E64616-000	JM-SIM-10S020SB	1.000	1.00 - 1.14	25.4 - 29.0	0.08 - 0.20	2.0 - 5.1
186120-000	JM-SIM-10S035S	1.000	1.00 - 1.14	25.4 - 29.0	0.27 - 0.35	6.9 - 8.9
A87868-000	JM-SIM-10S035SB	1.000	1.00 - 1.14	25.4 - 29.0	0.20 - 0.35	5.1 - 8.9
032536-000	JM-SIM-10S057SB	1.000	1.00 - 1.14	25.4 - 29.0	0.35 - 0.57	8.9 - 14.5
D36745-000	JM-SIM-10S065S	1.000	1.00 - 1.14	25.4 - 29.0	0.55 - 0.65	14.0 - 16.5
150356-000	JM-SIM-10S070SB	1.000	1.00 - 1.14	25.4 - 29.0	0.51 - 0.71	13.0 - 18.0
E23652-000	JM-SIM-11S020SB	1.100	1.12 - 1.26	28.4 - 32.0	0.08 - 0.20	2.0 - 5.1
C45061-000	JM-SIM-11S035SB	1.100	1.12 - 1.26	28.4 - 32.0	0.20 - 0.35	5.1 - 8.9
359872-000	JM-SIM-11S043S	1.100	1.12 - 1.26	28.4 - 32.0	0.35 - 0.43	8.9 - 10.9
120176-000	JM-SIM-11S057SB	1.100	1.12 - 1.26	28.4 - 32.0	0.35 - 0.57	8.9 - 14.5
289982-000	JM-SIM-11S070SB	1.100	1.12 - 1.26	28.4 - 32.0	0.51 - 0.71	13.0 - 18.0
564592-000	JM-SIM-11S078S	1.100	1.12 - 1.26	28.4 - 32.0	0.71 - 0.78	18.0 - 19.8
509746-000	JM-SIM-11S078SB	1.100	1.12 - 1.26	28.4 - 32.0	0.57 - 0.78	14.5 - 19.8
151270-000	JM-SIM-12S043S	1.250	1.22 - 1.36	31.0 - 34.5	0.35 - 0.43	8.9 - 10.9
C51983-000	JM-SIM-12S043SB-024H	1.250	1.22 - 1.36	31.0 - 34.5	0.24 - 0.43	6.1 - 10.9
960202-000	JM-SIM-12S057SB	1.250	1.22 - 1.36	31.0 - 34.5	0.35 - 0.57	8.9 - 14.5
33111D-000	JM-SIM-12S057S-FD1	1.250	1.22 - 1.36	31.0 - 34.5	Flat Drop .179 x .325x1	
101316-000	JM-SIM-12S057SB-043H	1.250	1.22 - 1.36	31.0 - 34.5	0.35 - 0.57	8.9 - 14.5
931062-000	JM-SIM-12S065S	1.250	1.22 - 1.36	31.0 - 34.5	0.55 - 0.65	14.0 - 16.5
YD8520-000	JM-SIM-12S065S-FD2	1.250	1.22 - 1.36	31.0 - 34.5	Flat Drop .179 x .325x2	
424922-000	JM-SIM-12S070SB	1.250	1.22 - 1.36	31.0 - 34.5	0.51 - 0.71	13.0 - 18.0
247320-000	JM-SIM-12S070SB-057H	1.250	1.22 - 1.36	31.0 - 34.5	0.51 - 0.71	13.0 - 18.0
E64727-000	JM-SIM-12S078SB	1.250	1.22 - 1.36	31.0 - 34.5	0.57 - 0.78	14.5 - 19.8
610036-000	JM-SIM-12S090SB	1.250	1.24 - 1.34	31.5 - 34.0	0.71 - 0.90	18.0 - 22.9
3S4902-000	JM-SIM-12S090S-FD3	1.250	1.24 - 1.34	31.5 - 34.0	Flat Drop .179 x .325x3	
360030-000	JM-SIM-12S090SB-078H	1.250	1.24 - 1.34	31.5 - 34.0	0.71 - 0.90	18.0 - 22.9
D34944-000	JM-SIM-13S043SB	1.375	1.37 - 1.50	34.8 - 38.1	0.12 - 0.43	3.0 - 10.9
F37918-000	JM-SIM-13S043SB-024H	1.375	1.37 - 1.50	34.8 - 38.1	0.24 - 0.43	6.1 - 10.9
240386-000	JM-SIM-13S057SB	1.375	1.37 - 1.50	34.8 - 38.1	0.35 - 0.57	8.9 - 14.5
201624-000	JM-SIM-13S070SB	1.375	1.37 - 1.50	34.8 - 38.1	0.51 - 0.71	13.0 - 18.0
539922-000	JM-SIM-13S097SB	1.375	1.33 - 1.46	33.8 - 37.1	0.71 - 0.97	18.0 - 24.6

(continued on page 3)

Suffix Definitions:

S	Standard PVC and PE ducts (ID)
B	Inner bushings included
A	Oversize ducts (ID)
#H	Hole plugs included
FD#	Bushing for flat fiber drop included

Fiber Optic Simplex Product Chart (continued from page 2)

Part No.	Description	Size	Duct ID		Cable OD	
			Inches	mm	Inches	mm
D21504-000	JM-SIM-15S020SB	1.500	1.46 - 1.65	37.1 - 41.9	0.08 - 0.20	2.0 - 5.1
A81771-000	JM-SIM-15S035SB	1.500	1.46 - 1.65	37.1 - 41.9	0.08 - 0.35	2.0 - 8.9
324948-000	JM-SIM15S043SB	1.500	1.46 - 1.65	37.1 - 41.9	0.08 - 0.43	2.0 - 10.9
E55265-000	JM-SIM15S043SB-024H	1.500	1.46 - 1.65	37.1 - 41.9	0.24 - 0.43	6.1 - 10.9
554508-000	JM-SIM-15S057SB	1.500	1.46 - 1.65	37.1 - 41.9	0.35 - 0.57	8.9 - 14.5
468786-000	JM-SIM-15S057SB-043H	1.500	1.46 - 1.65	37.1 - 41.9	0.35 - 0.57	8.9 - 14.5
299610-000	JM-SIM-15S065SB	1.500	1.46 - 1.65	37.1 - 41.9	0.46 - 0.65	11.7 - 16.5
751892-000	JM-SIM-15S070SB	1.500	1.46 - 1.65	37.1 - 41.9	0.51 - 0.71	13.0 - 18.0
106654-000	JM-SIM-15S070SB-057H	1.500	1.46 - 1.65	37.1 - 41.9	0.51 - 0.71	13.0 - 18.0
588288-000	JM-SIM-15S090SB	1.500	1.55 - 1.65	39.4 - 41.9	0.71 - 0.90	18.0 - 22.9
D15639-000	JM-SIM-15S090SB-078H	1.500	1.55 - 1.65	39.4 - 41.9	0.71 - 0.90	18.0 - 22.9
428444-000	JM-SIM-15S110SB	1.500	1.55 - 1.65	39.4 - 41.9	0.90 - 1.10	22.9 - 27.9
582536-000	JM-SIM-15S070AB	1.500	1.58 - 1.73	40.1 - 43.9	0.51 - 0.71	13.0 - 18.0
790542-000	JM-SIM-15S090AB	1.500	1.58 - 1.73	40.1 - 43.9	0.71 - 0.90	18.0 - 22.9
331954-000	JM-SIM-15S110AB	1.500	1.58 - 1.73	40.1 - 43.9	0.90 - 1.10	22.9 - 27.9
D44866-000	JM-SIM-20S020SB	2.000	1.82 - 1.97	46.2 - 50.0	0.08 - 0.20	2.0 - 5.1
D82343-000	JM-SIM-20S035SB	2.000	1.82 - 1.97	46.2 - 50.0	0.08 - 0.35	2.0 - 8.9
C10624-000	JM-SIM-20S043SB-024H	2.000	1.82 - 1.97	46.2 - 50.0	0.24 - 0.43	6.1 - 10.9
F70795-000	JM-SIM-20S043S	2.000	1.82 - 1.97	46.2 - 50.0	0.35 - 0.43	8.9 - 10.9
819946-000	JM-SIM-20S057SB	2.000	1.82 - 1.97	46.2 - 50.0	0.35 - 0.57	8.9 - 14.5
520796-000	JM-SIM-20S070SB	2.000	1.82 - 1.97	46.2 - 50.0	0.51 - 0.71	13.0 - 18.0
855814-000	JM-SIM-20S090SB	2.000	1.82 - 1.97	46.2 - 50.0	0.71 - 0.90	18.0 - 22.9
986500-000	JM-SIM-20S110SB	2.000	1.82 - 1.97	46.2 - 50.0	0.90 - 1.10	22.9 - 27.9
119892-000	JM-SIM-21S020SB	2.100	1.98 - 2.18	50.3 - 55.4	0.08 - 0.20	2.0 - 5.1
D12262-000	JM-SIM-21S035SB	2.100	1.98 - 2.18	50.3 - 55.4	0.20 - 0.35	5.1 - 8.9
908720-000	JM-SIM-21S035S	2.100	1.98 - 2.18	50.3 - 55.4	0.27 - 0.35	6.9 - 8.9
564402-000	JM-SIM-21S043SB	2.100	1.98 - 2.18	50.3 - 55.4	0.35 - 0.43	8.9 - 10.9
F70711-000	JM-SIM-21S050S	2.100	1.98 - 2.18	50.3 - 55.4	0.43 - 0.50	10.9 - 12.7
190356-000	JM-SIM-21S057SB	2.100	1.98 - 2.18	50.3 - 55.4	0.35 - 0.57	8.9 - 14.5
906724-000	JM-SIM-21S070SB	2.100	1.98 - 2.18	50.3 - 55.4	0.51 - 0.71	13.0 - 18.0
923872-000	JM-SIM-21S090SB	2.100	1.98 - 2.18	50.3 - 55.4	0.71 - 0.90	18.0 - 22.9
914472-000	JM-SIM-21S110SB	2.100	1.98 - 2.18	50.3 - 55.4	0.90 - 1.10	22.9 - 27.9
595426-000	JM-SIM-21S110AB	2.100	2.14 - 2.22	54.4 - 56.4	0.90 - 1.10	22.9 - 27.9

Suffix Definitions:

- S Standard PVC and PE ducts (ID)
- B Inner bushings included
- A Oversize ducts (ID)
- #H Hole plugs included
- FD# Bushing for flat fiber drop included

Tyco Electronics Corporation

8000 Purfoy Road
Fuquay-Varina, NC 27526-3000
Tel.: 919-557-8900
Fax: 919-557-8498
www.tycoelectronics.com

Tyco Electronics and the TE logo are trademarks.

The information given herein, including drawings, illustrations, charts and schematics which are intended for illustration purposes only, is believed to be reliable. However, Tyco Electronics makes no warranties as to its accuracy or completeness and disclaims any liability in connection with its use. Tyco Electronics' obligations shall only be as set forth in Tyco Electronics' Standard Terms and Conditions of Sale for this product and in no case will Tyco Electronics be liable for any incidental, indirect or consequential damages arising out of the sale, resale, use or misuse of the product. Users of Tyco Electronics products should make their own evaluation to determine the suitability of each such product for the specific application.